

PROJECT: BPI.R005.1 REFERENCE: SF-880023

CONTENTS

<u>SHEET NO.</u>	<u>DESCRIPTION</u>
1	TITLE SHEET
2	LEGEND (SOIL & ROCK)
3	SITE PLAN
4	PROFILE
5	BORE LOG

STATE OF NORTH CAROLINA
DEPARTMENT OF TRANSPORTATION
DIVISION OF HIGHWAYS
GEOTECHNICAL ENGINEERING UNIT

STRUCTURE
SUBSURFACE INVESTIGATION

COUNTY TYRRELL
 PROJECT DESCRIPTION CULVERT NO. 23 ON -L- (SR 1118)
OVER BONARVA CANAL AT STA. 13+36

STATE	STATE PROJECT REFERENCE NO.	SHEET NO.	TOTAL SHEETS
N.C.	SF-880023	1	5

CAUTION NOTICE

THE SUBSURFACE INFORMATION AND THE SUBSURFACE INVESTIGATION ON WHICH IT IS BASED WERE MADE FOR THE PURPOSE OF STUDY, PLANNING AND DESIGN, AND NOT FOR CONSTRUCTION OR PAY PURPOSES. THE VARIOUS FIELD BORING LOGS, ROCK CORES AND SOIL TEST DATA AVAILABLE MAY BE REVIEWED OR INSPECTED IN RALEIGH BY CONTACTING THE N. C. DEPARTMENT OF TRANSPORTATION, GEOTECHNICAL ENGINEERING UNIT AT (919) 707-6850. THE SUBSURFACE PLANS AND REPORTS, FIELD BORING LOGS, ROCK CORES AND SOIL TEST DATA ARE NOT PART OF THE CONTRACT.

GENERAL SOIL AND ROCK STRATA DESCRIPTIONS AND INDICATED BOUNDARIES ARE BASED ON A GEOTECHNICAL INTERPRETATION OF ALL AVAILABLE SUBSURFACE DATA AND MAY NOT NECESSARILY REFLECT THE ACTUAL SUBSURFACE CONDITIONS BETWEEN BORINGS OR BETWEEN SAMPLED STRATA WITHIN THE BOREHOLE. THE LABORATORY SAMPLE DATA AND THE IN SITU (IN-PLACE) TEST DATA CAN BE RELIED ON ONLY TO THE DEGREE OF RELIABILITY INHERENT IN THE STANDARD TEST METHOD. THE OBSERVED WATER LEVELS OR SOIL MOISTURE CONDITIONS INDICATED IN THE SUBSURFACE INVESTIGATIONS ARE AS RECORDED AT THE TIME OF THE INVESTIGATION. THESE WATER LEVELS OR SOIL MOISTURE CONDITIONS MAY VARY CONSIDERABLY WITH TIME ACCORDING TO CLIMATIC CONDITIONS INCLUDING TEMPERATURES, PRECIPITATION AND WIND, AS WELL AS OTHER NON-CLIMATIC FACTORS.

THE BIDDER OR CONTRACTOR IS CAUTIONED THAT DETAILS SHOWN ON THE SUBSURFACE PLANS ARE PRELIMINARY ONLY AND IN MANY CASES THE FINAL DESIGN DETAILS ARE DIFFERENT. FOR BIDDING AND CONSTRUCTION PURPOSES, REFER TO THE CONSTRUCTION PLANS AND DOCUMENTS FOR FINAL DESIGN INFORMATION ON THIS PROJECT. THE DEPARTMENT DOES NOT WARRANT OR GUARANTEE THE SUFFICIENCY OR ACCURACY OF THE INVESTIGATION MADE, NOR THE INTERPRETATIONS MADE, OR OPINION OF THE DEPARTMENT AS TO THE TYPE OF MATERIALS AND CONDITIONS TO BE ENCOUNTERED. THE BIDDER OR CONTRACTOR IS CAUTIONED TO MAKE SUCH INDEPENDENT SUBSURFACE INVESTIGATIONS AS HE DEEMS NECESSARY TO SATISFY HIMSELF AS TO CONDITIONS TO BE ENCOUNTERED ON THE PROJECT. THE CONTRACTOR SHALL HAVE NO CLAIM FOR ADDITIONAL COMPENSATION OR FOR AN EXTENSION OF TIME FOR ANY REASON RESULTING FROM THE ACTUAL CONDITIONS ENCOUNTERED AT THE SITE DIFFERING FROM THOSE INDICATED IN THE SUBSURFACE INFORMATION.

- NOTES:
1. THE INFORMATION CONTAINED HEREIN IS NOT IMPLIED OR GUARANTEED BY THE N. C. DEPARTMENT OF TRANSPORTATION AS ACCURATE NOR IS IT CONSIDERED PART OF THE PLANS, SPECIFICATIONS OR CONTRACT FOR THE PROJECT.
 2. BY HAVING REQUESTED THIS INFORMATION, THE CONTRACTOR SPECIFICALLY WAIVES ANY CLAIMS FOR INCREASED COMPENSATION OR EXTENSION OF TIME BASED ON DIFFERENCES BETWEEN THE CONDITIONS INDICATED HEREIN AND THE ACTUAL CONDITIONS AT THE PROJECT SITE.

PERSONNEL

S.N. ZIMARINO

R.E. SMITH

C.M. WALKER

INVESTIGATED BY T.C. BOTTOMS

DRAWN BY T.C. BOTTOMS

CHECKED BY D.N. ARGENBRIGHT

SUBMITTED BY D.N. ARGENBRIGHT

DATE JANUARY 2022



DocuSigned by:
Tyler Bottoms 02/07/2022

48A2D3BD08CF4A6...
 SIGNATURE DATE

**DOCUMENT NOT CONSIDERED FINAL
 UNLESS ALL SIGNATURES COMPLETED**

NORTH CAROLINA DEPARTMENT OF TRANSPORTATION
DIVISION OF HIGHWAYS
GEOTECHNICAL ENGINEERING UNIT
SUBSURFACE INVESTIGATION
SOIL AND ROCK LEGEND, TERMS, SYMBOLS, AND ABBREVIATIONS

Table with multiple columns: SOIL DESCRIPTION, GRADATION, ROCK DESCRIPTION, TERMS AND DEFINITIONS, SOIL LEGEND AND AASHTO CLASSIFICATION, MINERALOGICAL COMPOSITION, COMPRESSIBILITY, PERCENTAGE OF MATERIAL, GROUND WATER, MISCELLANEOUS SYMBOLS, RECOMMENDATION SYMBOLS, ABBREVIATIONS, EQUIPMENT USED ON SUBJECT PROJECT, FRACTURE SPACING, BEDDING, INDOURATION, PLASTICITY, and COLOR.

SITE PLAN

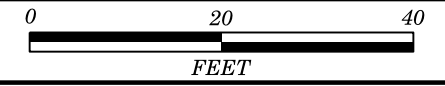

SKEW: 50°

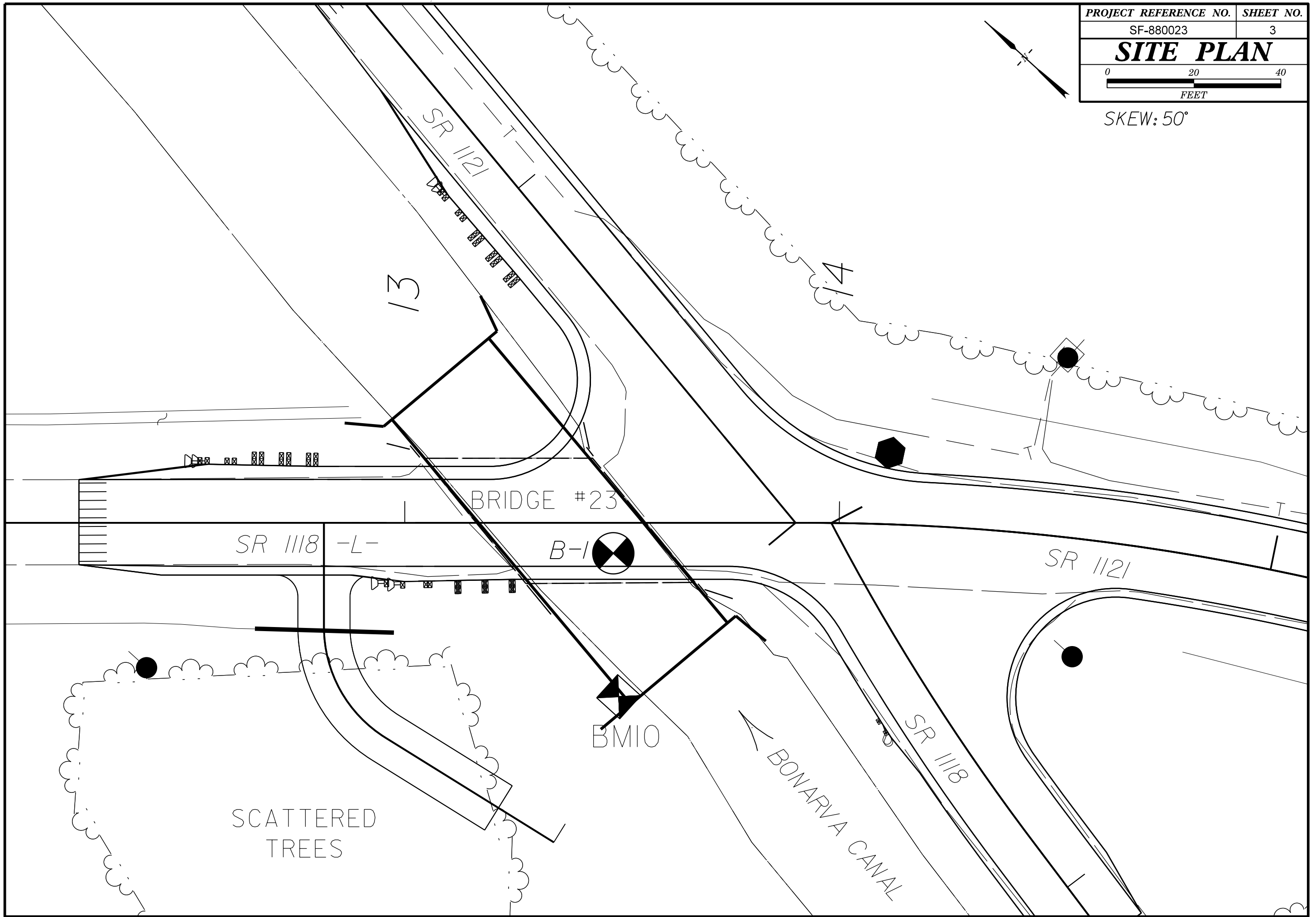
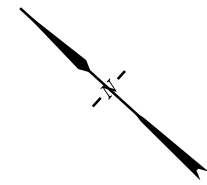

5/14/99

PROFILE THROUGH BORING PROJECTED ALONG -L-

PROJECT REFERENCE NO. <i>SF-880023</i>	SHEET NO. 4
ROADWAY DESIGN ENGINEER	HYDRAULICS ENGINEER
INCOMPLETE PLANS DO NOT USE FOR R/W ACQUISITION	
DOCUMENT NOT CONSIDERED FINAL UNLESS ALL SIGNATURES COMPLETED	

VE: 2

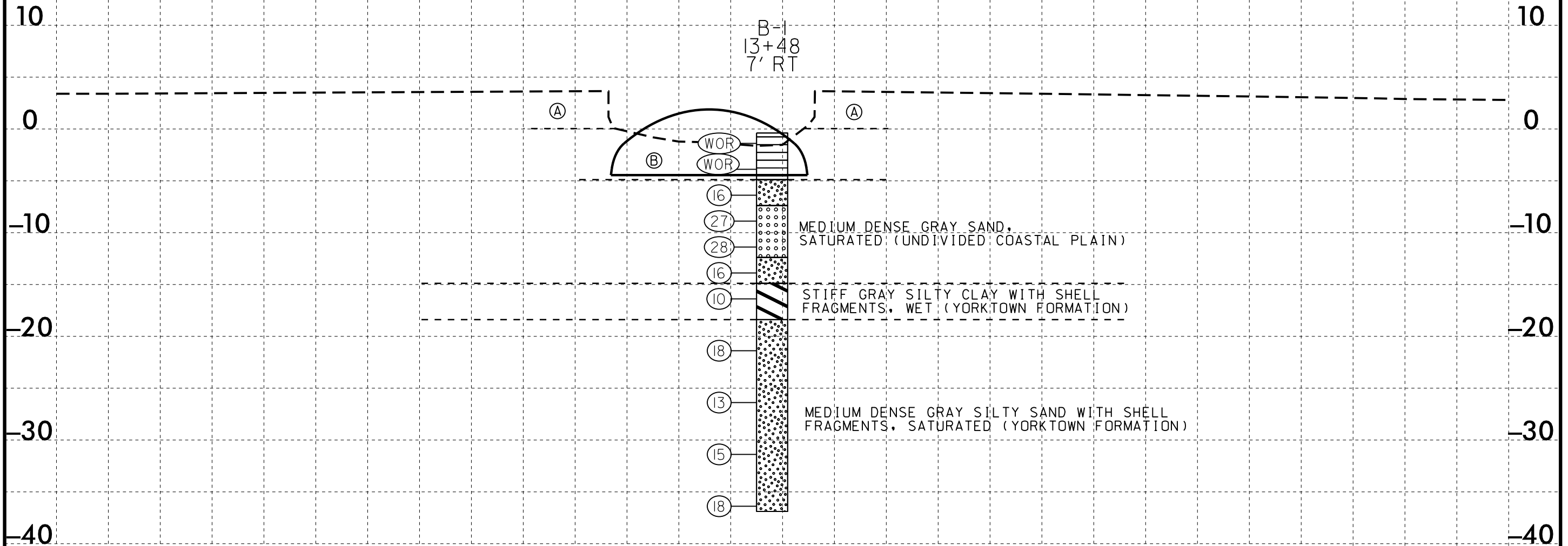

- (A) LOOSE TO MEDIUM DENSE TAN SAND, MOIST TO SATURATED (ROADWAY EMBANKMENT)
- (B) VERY SOFT BROWN SILT WITH LITTLE ORGANIC MATERIAL, WET (ALLUVIAL)

NOTE: GROUNDLINE PROFILE ALONG -L- TAKEN FROM CULVERT SURVEY AND HYDRAULIC DESIGN REPORT DATED 11/2/2021

NOTE: INFERRED STRATIGRAPHY IS DRAWN THROUGH THE BORING WITH BOTH PROJECTED ONTO THE PROFILE

03-FEB-2022 15:16
\\SF880023\030\CULV_PFL.dgn
\$\$\$\$\$

13

14

GEOTECHNICAL BORING REPORT

BORE LOG

WBS BP1.R005.1			TIP SF-880023			COUNTY TYRRELL			GEOLOGIST Zimarino, S. N.			
SITE DESCRIPTION CULVERT NO. 23 ON -L- (SR 1118) OVER BONARVA CANAL								GROUND WTR (ft)				
BORING NO. B-1			STATION 13+48			OFFSET 7 ft RT			ALIGNMENT -L-			0 HR. N/A
COLLAR ELEV. -0.3 ft			TOTAL DEPTH 36.5 ft			NORTHING 771,290			EASTING 2,781,434			24 HR. N/A
DRILL RIGHAMMER EFF./DATE GFC0075 CME-45C 92%/08/13/2020						DRILL METHOD Mud Rotary			HAMMER TYPE Automatic			
DRILLER Smith, R. E.			START DATE 02/10/21			COMP. DATE 02/10/21			SURFACE WATER DEPTH 1.9ft			

ELEV (ft)	DRIVE ELEV (ft)	DEPTH (ft)	BLOW COUNT			BLOWS PER FOOT					SAMP. NO.	LOG MOI	L O G	SOIL AND ROCK DESCRIPTION		
			0.5ft	0.5ft	0.5ft	0	25	50	75	100				ELEV. (ft)	DEPTH (ft)	
0	-0.3	0.0													WATER SURFACE (02/10/21)	
	-2.8	2.5	WOR	WOR	WOR										GROUND SURFACE 0.0	
	-5.3	5.0	WOR	WOR	WOR										ALLUVIAL BROWN SILT WITH LITTLE ORGANIC MATERIAL, WET	
	-7.8	7.5	WOH	7	9										UNDIVIDED COASTAL PLAIN	
	-10.3	10.0													GRAY SAND AND SILTY SAND, SATURATED	
	-12.8	12.5														
	-15.3	15.0													COASTAL PLAIN	
	-18.3	18.0													GRAY SILTY CLAY, WET (YORKTOWN FORMATION)	
	-20.3	20.0													GRAY SILTY SAND WITH SHELL FRAGMENTS, SATURATED (YORKTOWN FORMATION)	
	-25.3	25.0														
	-30.3	30.0														
	-35.3	35.0													Boring Terminated at Elevation -36.8 ft in Medium Dense Silty Sand	

NCDOT BORE DOUBLE SF880023_GEO_CULV.GPJ_NC_DOT.GDT 2/3/22